

Resp. :

Workshop

Situation



Tools / Components

Item to Install / Uninstall



Tool

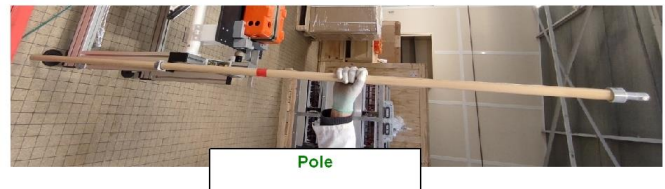

**Operation 1 : Install the GPR300**

Basic operations	Security	Self-Controle	Instruction	Gestual
1- Load the product on the bench			Poka-Yoke	
2- Connect the product				○
3- Unlock the cart			Unlock the latch Push the cart	
4- Insert the pole			Put the locating bolt horizontally	
5- Lock			1/4 turn	
6- Place the product in the coil		Until the gray mark is correctly positioned	Push with the pole	
7- Check that the cart is blocked		Move the pole back and forward until the cart locks.		○

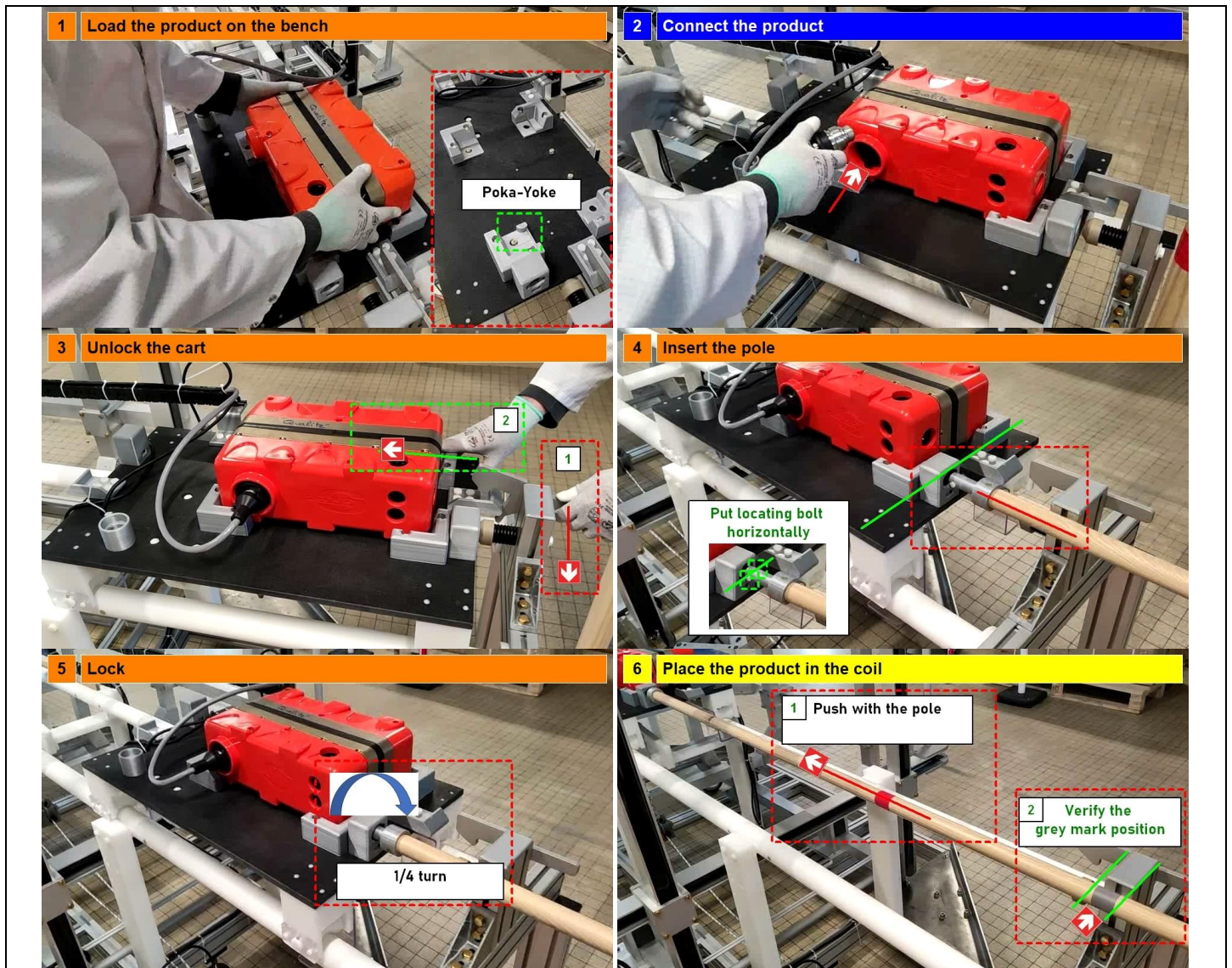

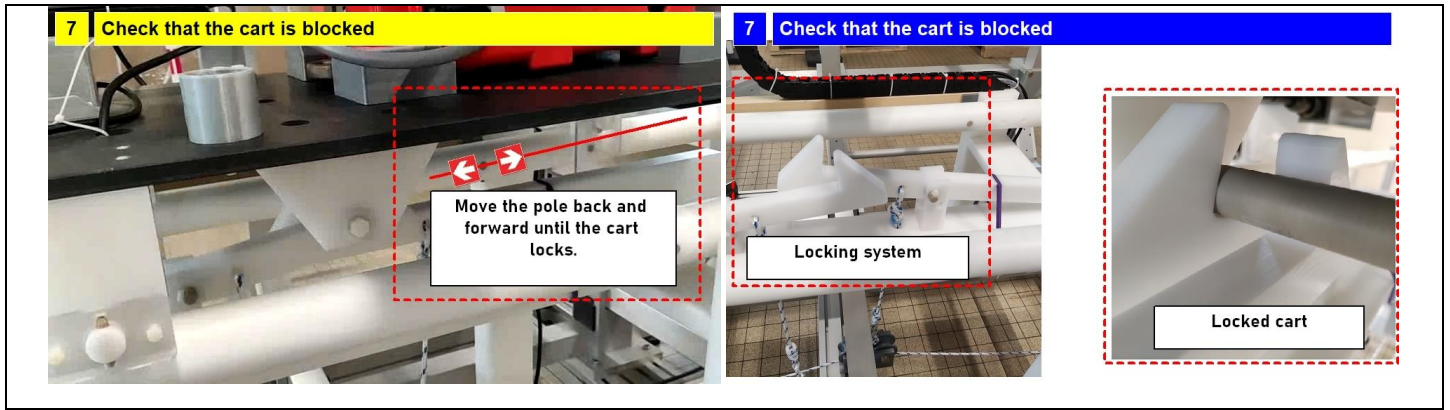

**Operation 2 : Uninstall the GPR300**

Basic operations	Security	Self-Controle	Instruction	Gestual
1- Insert the pole			Put the locating bolt horizontally Insert in the fastening system Lock the pole: 1/4 turn	
2- Unlock the cart			Press the pedal The cart unlocks.	
3- Take out the cart			Pull with the pole	
4- Completely remove the cart			Until the latch is locked	
5- Take off the pole			Unlock the pole	
6- Unplug the connector				○
7- Store the connector				○
8- Remove the GPR300				○

